

HQC Series Automatic Flow-Controlled Pump



Power: 0.18 - 0.75 kW

50Hz

Head: Up to 3.5 kg/cm²

Flow: Up to 95 L/min

60Hz

Head: Up to 4.4 kg/cm²

Flow: Up to 90 L/min

Outlet: 1"

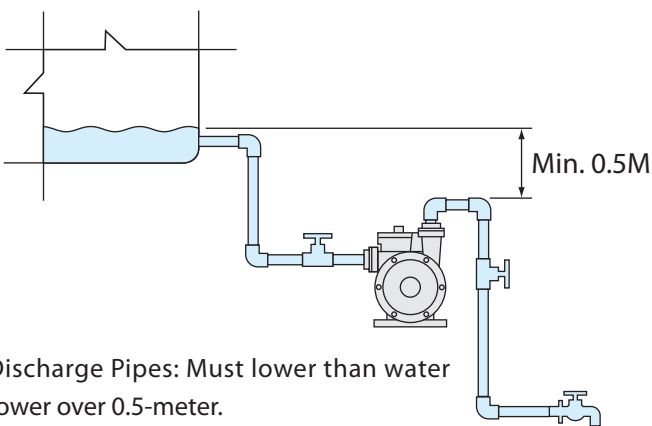

Discharge Pipes: Must lower than water tower over 0.5-meter.

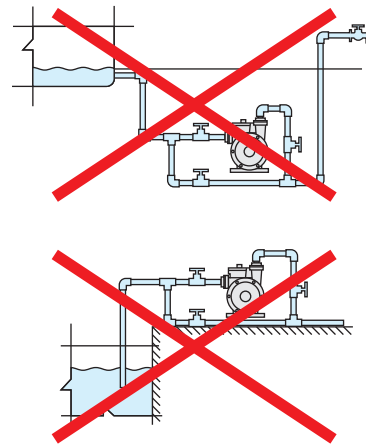

Product Features

1. This HQC series most suitable to install it below the water tower, to downward pressurization, When using the water; the pump will automatically start increase the pressure to supply water, when stop using the pump will automatically stop supply power and water.
2. Compact design and quiet operation make the HQC series suitable for many applications.
3. The HQC is constructed from the top quality corrosion resistant materials.
4. The motor has built-in thermal overload to protect against high operating temperatures and over current.

Operating Conditions

1. Ambient temperature: Max. +40°C
2. Liquid temperature: + 4°C ~ + 40°C
3. Pressure Range : Max. 6kg/cm²
4. Suction Pipes: Must run in positive pressure only a negative pressure unable to work the pump.
5. Discharge Pipes: Must lower than water tower over 0.5-meter.

Dimensions

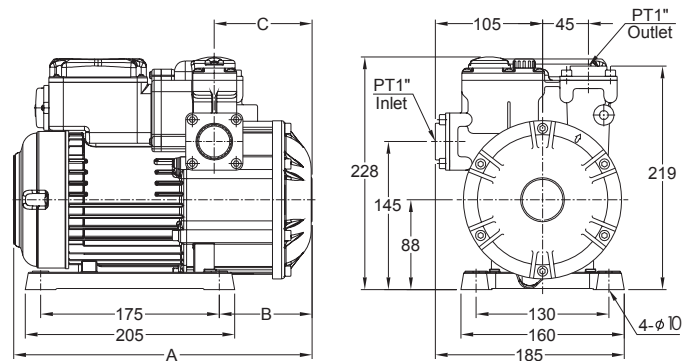

Model	Cycle (Hz)	Dimensions (mm)		
		A	B	C
HQC200	50 / 60	292	91	96
HQC400	50 / 60	292	91	96
HQC800	50 / 60	344	96	101

Performance curve:

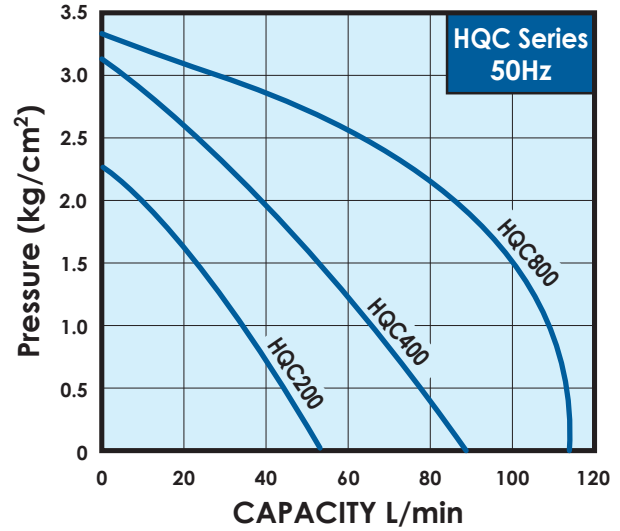
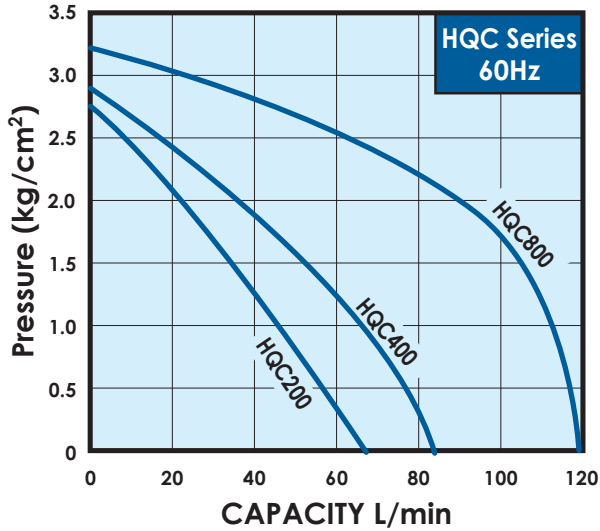

Specification, 50Hz

Model	Power (kW)	Cycle (Hz)	Phase (∅)	Voltage (V)	Amp's (A)	Inlet (in.)	Outlet (in.)	P max. (kg/cm ²)	Q max. (L/min)	N.W. (kg)	
HQC200	0.18	50	1	200~240	1.5	1"	1"	2.4	55	7.3	36
HQC400	0.37	50	1	200~240	2.8	1"	1"	3.1	85	8.3	36
HQC800	0.75	50	1	200~240	4.5	1"	1"	3.3	110	11.1	30

Specification, 60Hz

Model	Power (kW)	Cycle (Hz)	Phase (∅)	Voltage (V)	Amp's (A)	Inlet (in.)	Outlet (in.)	P max. (kg/cm ²)	Q max. (L/min)	N.W. (kg)	
HQC200	0.18	60	1	110/220	4.0/2.0	1"	1"	2.4	60	7.3	36
HQC400	0.37	60	1	110/220	6.0/3.0	1"	1"	2.6	80	8.3	36
HQC800	0.75	60	1	110/220	9.0/4.5	1"	1"	2.8	120	10.6	30